

GENERAL DESCRIPTION

This product is used to make base sounders suitable to mount **L-OP-SG**, **L-MC-SG** e **L-HT-SG** detectors.

HOW TO USE

1. Unscrew and extract the two base sounder's screws indicated by the arrows in picture 1.
2. Cautiously extract the existing adaptor base from the base sounder's main block.

Picture 1

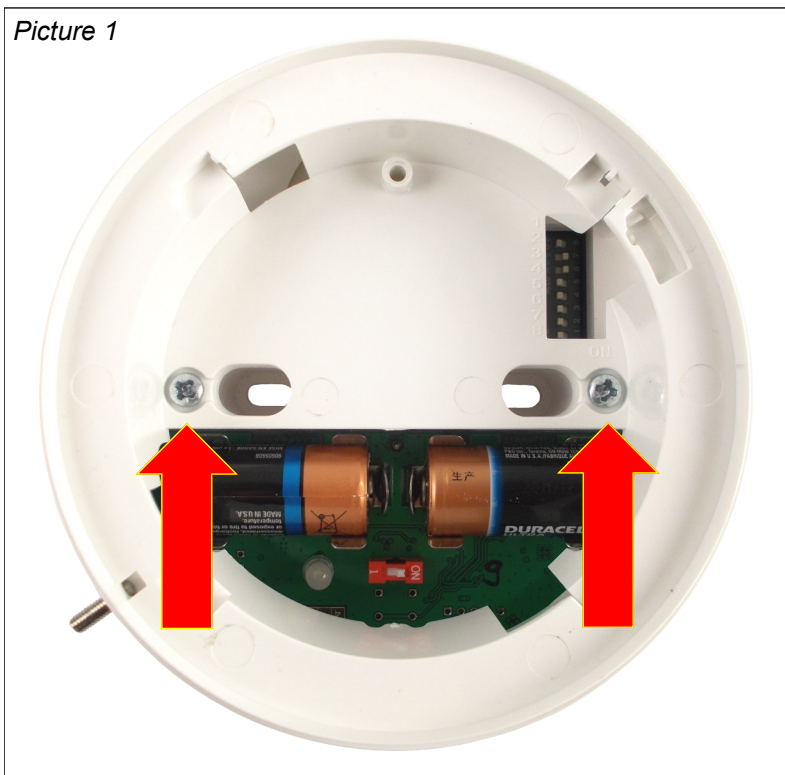

3. Make sure the antenna is well inserted in its PCB connector's slot; original adaptor base's extraction could have dislodged the base of the antenna.

Picture 2

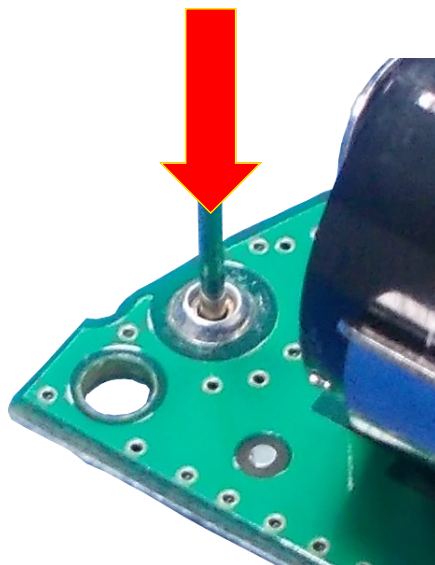
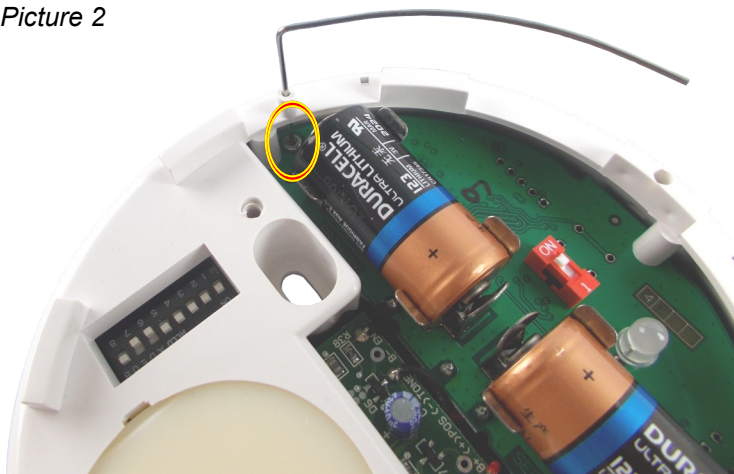

WARNING !



**IF THE ANTENNA IS NOT INSTALLED PROPERLY, THE BASE SOUNDER WILL
BE UNABLE TO COMMUNICATE WITH ITS MASTER MODULE !**

4. Make sure the antenna is aligned along the border of the base sounder as in picture 3.

Picture 3

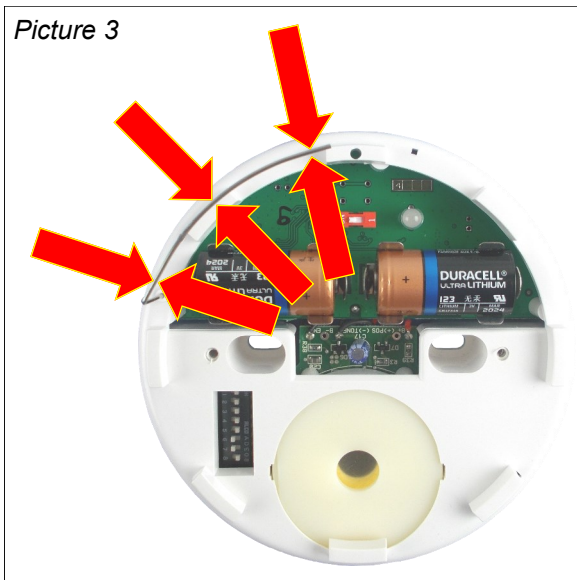

5. Cautiously install the **LA-BSC-01** onto the base sounder's main block. The antenna must fit into its **LA-BSC-01**'s lodgment. Take care not to bend or damage the antenna.
6. Secure the **LA-BSC-01** with the supplied screws (picture 4); if you prefer you can use the old screws instead.

Picture 4

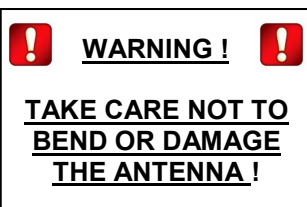
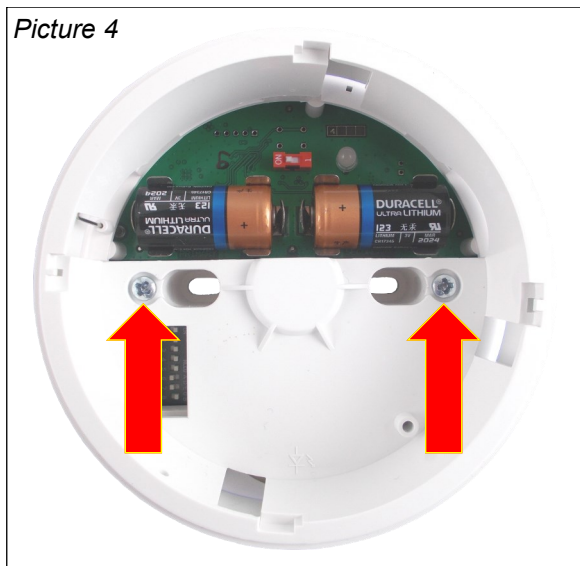

7. Have a last check to the integrity of the antenna and its connection to the PCB connector.

Picture 5

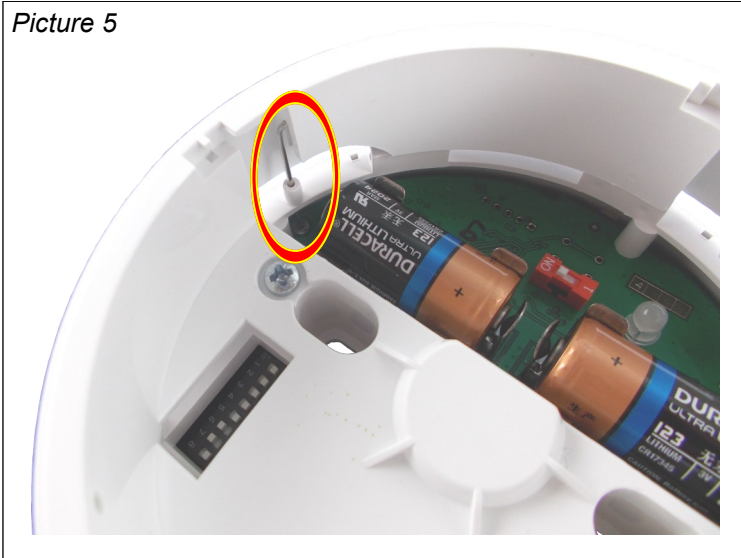

WARNINGS AND LIMITATIONS

Our devices use high quality electronic components and plastic materials that are highly resistant to environmental deterioration. However, after 10 years of continuous operation, it is advisable to replace the devices in order to minimize the risk of reduced performance caused by external factors. Ensure that this device is only used with compatible control panels. Detection systems must be checked, serviced and maintained on a regular basis to confirm correct operation. Smoke sensors may respond differently to various kinds of smoke particles, thus application advice should be sought for special risks. Sensors cannot respond correctly if barriers exist between them and the fire location and may be affected by special environmental conditions. Refer to and follow national codes of practice and other internationally recognized fire engineering standards. Appropriate risk assessment should be carried out initially to determine correct design criteria and updated periodically.

WARRANTY

All devices are supplied with the benefit of a limited 3 year warranty relating to faulty materials or manufacturing defects, effective from the production date indicated on each product. This warranty is invalidated by mechanical or electrical damage caused in the field by incorrect handling or usage. Product must be returned via your authorized supplier for repair or replacement together with full information on any problem identified. Full details on our warranty and product's returns policy can be obtained upon request.