

FI100

REMOTE INDICATOR LAMP

GENERAL DESCRIPTION

The **FI100** remote indicator unit is designed for fire detection systems requiring local indication of an individual or a group of fire detectors in alarm utilising a LED having a wide area of illumination and an high on / off contrast.

The **FI100** is a LED optical repeater, for both conventional and analogue fire detectors, that eliminates the necessity to install two types of devices. It combines small dimensions, high efficiency and low power consumption. The **FI100** is controlled and powered directly by the detector.

APPLICATION

An **FI100**, placed outside a room which is protected by fire detectors, allows its fast localization if an alarm condition arises. The device can be mounted on a wall or a ceiling.



CAUTION
Electrostatic sensitive device
Observe precautions when handling and making connections

TECHNICAL SPECIFICATIONS

Specifications	Min	Typical	Max	Units	Comments
Operating voltage	15	24	40	V	
Current consumption intelligent loop	2	4.2	7.6	mA	
Current consumption conventional loop	2	4.2	7.6	mA	Note: an external 4K7 resistor must be connected for current limitation
Housing material	ABS				
Transparent window color	Red				
Maximum wire gauge	2.5 mm ²				
Operating temperature	From -30° to +70°C				
Dimensions	80 mm x 80 mm x 27 mm				
Weight	30 grams				
Mounting	Flush				
IP rating	IP42				

Installation instructions

1. Install directly on the wall or ceiling using four screws; in case of recessed installation use a standard 60 mm box and attach to this through the appropriate openings (see image on the following page).
2. Connect the cables as follows:
 - a. Negative to "-COMMON"
 - b. Positive to "+ A" if you use analog system
 - c. Positive to "+ C" if conventional system is used

Note: If there is no current limitation from the analog system a 4K7 resistor must be installed in series to the "+A" terminal in order to avoid device damage. For proper operation, a maximum current of 10mA must not be exceeded.

Rear View

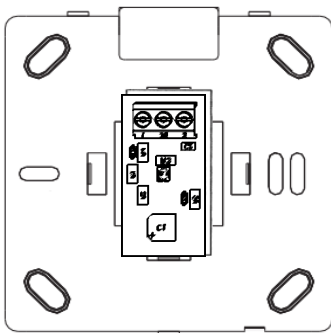
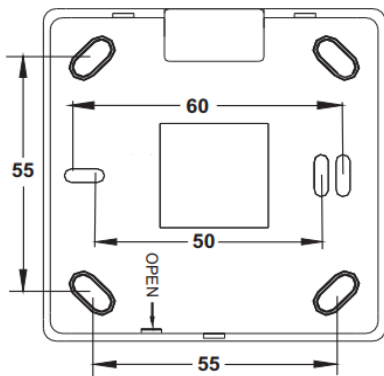

Front View

Tube entry max. 20mm

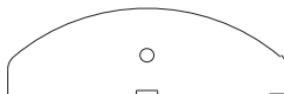
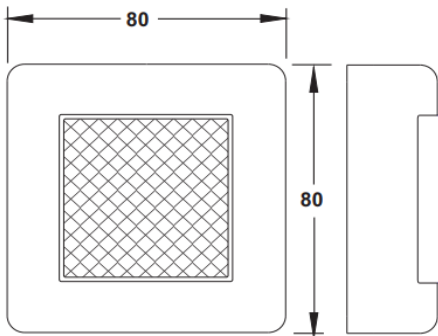
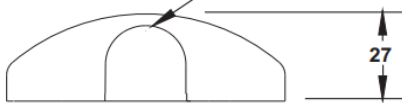

WARNINGS AND LIMITATIONS

Our devices use high quality electronic components and plastic materials that are highly resistant to environmental deterioration. However, after 10 years of continuous operation, it is advisable to replace the devices in order to minimize the risk of reduced performance caused by external factors. Ensure that this device is only used with compatible control panels. Detection systems must be checked, serviced and maintained on a regular basis to confirm correct operation. Smoke sensors may respond differently to various kinds of smoke particles, thus application advice should be sought for special risks. Sensors cannot respond correctly if barriers exist between them and the fire location and may be affected by special environmental conditions. Refer to and follow national codes of practice and other internationally recognized fire engineering standards. Appropriate risk assessment should be carried out initially to determine correct design criteria and updated periodically.

WARRANTY

All devices are supplied with the benefit of a limited 5 year warranty relating to faulty materials or manufacturing defects, effective from the production date indicated on each product. This warranty is invalidated by mechanical or electrical damage caused in the field by incorrect handling or usage. Product must be returned via your authorized supplier for repair or replacement together with full information on any problem identified. Full details on our warranty and product's returns policy can be obtained upon request.



ARGUS SECURITY S.R.L.
Via del Canneto, 14
34015 Muggia (TS)
Italy

F1100

For use in compatible fire detection and alarm system